

# Personal Space

## *Landline*

Sept 24 - Nov 5, 2023

Opening Sunday Sept 24, 2-5pm

Bimbola Akinbola, Caleb Jamel Brown, Ajit Chauhan, Julio del Rio, Christopher Robin Duncan, Sam Finkelstein, Gabriel Garza, Gordon Hall, Justine Kablack, Em Kettner, Connie Lee, Susan Metrican, Sandra Ono, Sara Osebold, J Rivera Pansa, Mel Prest, Tracy Ren, Julio Rodriguez, and Chris Thorson.



Personal Space is thrilled to present our second exhibition *Landline*, which assembles the work of artists from Atlanta, Northern California, Chicago, Maine, New York, Iowa, and Seattle. Channeling analog modes of communication, these works seem to conjure ethereal portals to another realm while simultaneously rooting themselves in the natural world. Images and objects that transmit ancient relics, spiritual talismans, and imaginative figments manifest through various mastery of shape, form, materiality, texture and color. At once worldly and otherworldly, these works straddle a line etched between past, present, and the unknown.

The exhibition includes two commissioned works as part of Personal Space's ongoing *New Works* series: a poem by Cedar Sigo (designed by Connie Lee, printed by Colpa Press) and the gallery's rotating exterior sign space by Gabriel Garza. A live performance by John Davis will take place during the opening reception.



# Personal Space

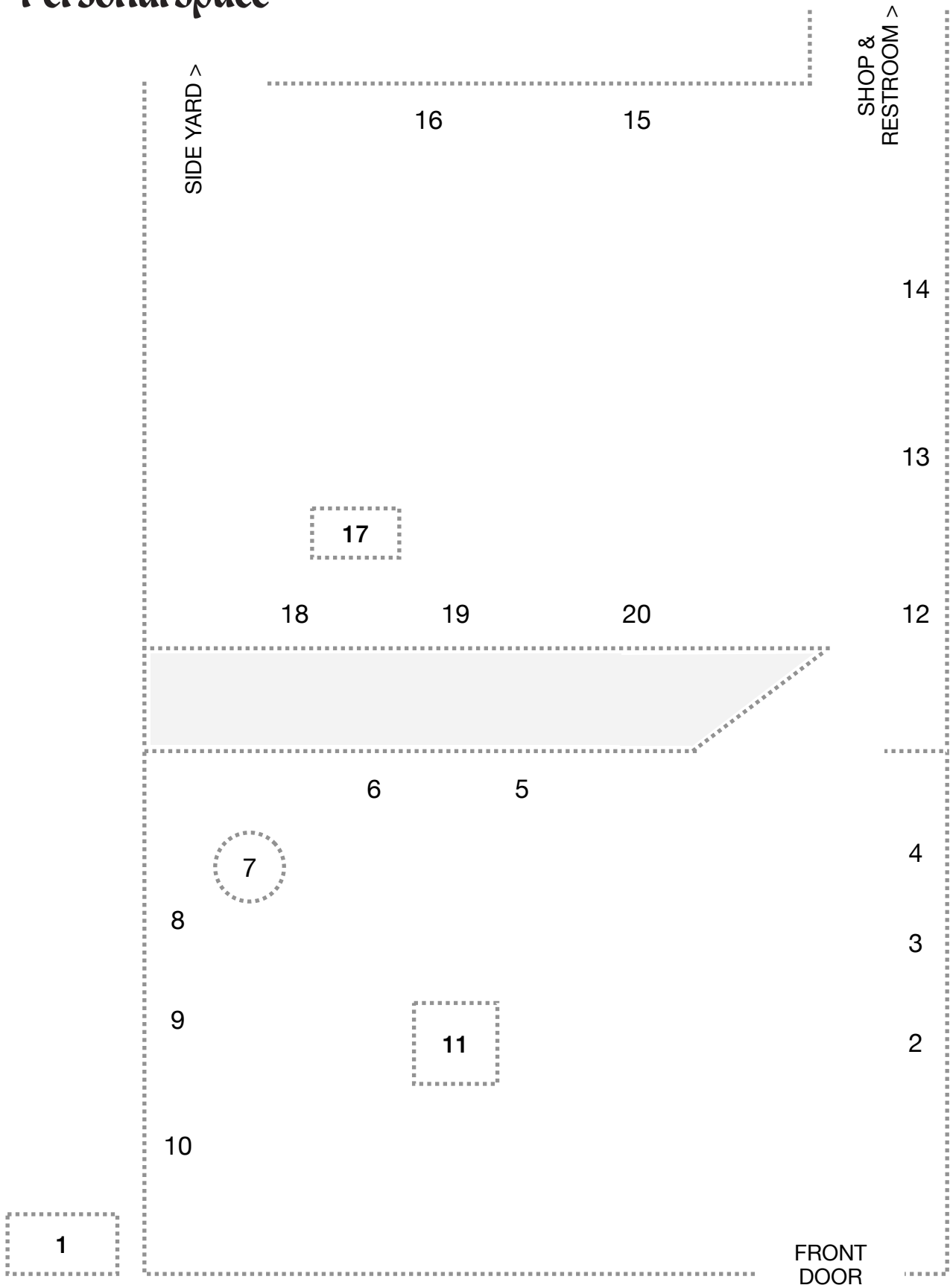

# Personal Space

1. Gabriel Garza (outdoor sign space)  
*Yes, Yes, Yes, Yes* (2023)  
Enamel on Wood
2. Em Kettner  
*The Hereafter* (2023)  
Handwoven cotton and silk in  
black walnut artist's frame  
10 x 5 x 1" \$3,000
3. Connie Lee  
*Two Sofa Cushions* (2023)  
Charcoal and graphite on paper  
in custom frame  
12.5 x 15.5 x 1.5" framed \$850
4. Chris Thorson  
*Untitled* (2023) *Untitled* (2022)  
Patinated Bronze  
Each 3.25 x 1.5 x 1" \$500 each
5. Chris Duncan  
*SYMBOL/CYMBAL (ONE YEAR)* (2023)  
6 month exposure: Sun, time, oil, and  
ink on fabric  
28 x 20" \$6,500
6. Gordon Hall  
*Sash* (2021)  
Screen print on paper with artist's peg  
Signed and numbered, edition of 50  
28 x 5 x 3" \$250
7. Tracy Ren  
*River Rocks Ripple* (2023)  
Ceramic, glaze, Russian River rocks  
16 x 16 x 1.5" \$2,000
8. Bimbola Akinbola  
*Ancestor Work Study #1* (2022)  
Gouache on woven paper in custom frame  
15.25 x 12.75" framed \$1,000
9. Susan Metrican  
*Lucky Sleeping*  
Acrylic on canvas, cotton, recycled  
cotton stuffing, thread  
25 x 25 x 1.5" \$2,400
10. Sandra Ono  
*Untitled* (2023)  
Sand, pearl and earrings  
5 x 5 x 1.25" Not for sale
11. Sam Finkelstein  
*Udder* (2022)  
Quarried granite  
7.5 x 9 x 5.5" \$2,200
12. Julio Rodriguez  
*Resolution* (2023)  
Acrylic on canvas  
7 x 5" \$220
13. Julio del Rio  
*Untitled* (2018)  
Graphite on paper  
25.5 x 37.5" framed \$700
14. Ajit Chauhan  
🌍🌍, *Hobbiton*, and *Hey Mr. Rain*  
Found image, cast acrylic, matboard  
Each approx 8 x 7 x .5" \$1,200 each
15. Susan Metrican  
*Smoking Late July* (2021)  
Acrylic on canvas, thread  
24 x 22 x 1.5" \$2,400
16. Sara Osebold  
*Veins are to Rivers* (2023)  
Watercolor, graphite and colored  
pencil on Lokta paper  
14 x 11" framed \$450
17. J Rivera Pansa  
*A.G.L. X 15* (2023)  
Glass, lavender buds, faraday fabric,  
tin/lead solder  
1 3/8" x 16" x 10" \$4,000
18. Justine Kablack  
*5555 (Watching the dash cam while  
Sam and Dylan talk shit in the back/  
Building an altar on a summer night)*  
Graphite on paper  
11 x 9" \$600
19. Caleb Jamel Brown  
*Twin Leos* (2022)  
Inkjet print, synthetic thread, mineral  
paper, spray paint, and silver gelatin  
print on Mylar  
20.75 x 16.75" framed \$1,200
20. Mel Prest  
*Untitled Fragment* (2019)  
Glass. 11 x 7 x 1/8" \$1,000



# Personal Space

**Bimbola Akinbola** is an artist, performer, and scholar currently based in Chicago. Her scholarly and artistic work is concerned with the complicated and nagging nature of belonging, queerness, and the concept of family. Incorporating a variety of practices ranging from drawing and painting to rubbing her make-up stained skin across surfaces and durational social dance, her work explores mark-making and performance as modes of organization, remembrance, and repair. Bimbola has a B.A in American Studies and Studio Art from Macalester College, and a PhD in American Studies from the University of Maryland, College Park. She is an Assistant Professor of Performance Studies at Northwestern University.

**Caleb Jamel Brown** (b.1993) is a multidisciplinary artist and plumber from Atlanta, GA. Brown uses a myriad of media, from photography and installation to painting and sculpture, to investigate the intersections of Black American material culture, representation through abstraction, and familial memory. Much his work is inspired by old vernacular photos from family members, the adornment of Black interior spaces, hand-me-down garments, knick-knacks, and kitschy décor giving much of my work in devotional quality where the past and lives of elders are preserved and celebrated through objects and artefacts. The Utilisation of abstraction and vernacular as the foundation for larger cultural narratives is at the core of his practice. Caleb is a 2022 Working Artist Project recipient and a 2020 Mint Leap Year Fellow. Caleb holds a BFA from Valdosta State University and has participated in residencies throughout the United States and abroad including Shandaken: StormKing, New Windsor, NY; Mass MOCA; PATA, Lodz, Poland; Proyecto Ace, Buenos Aires, Argentina; Coleman Arts Center, York, Al; Aviario, Portugal.

**Ajit Chauhan** (b. 1981) lives in the sanctuary city of San Francisco, California. He works with adults with developmental disabilities, plays with cats & practices tai chi. His work has been exhibited at the Saatchi Gallery in London, White Columns NY, CCA Wattis Institute for Contemporary Arts, San Francisco Museum of Modern Art, the Berkeley Art Museum, Asian Art Museum, UC Davis Museum, the Grimm Museum in Berlin, the SONS Museum in Kruishoutem, Belgium, Jack Hanley Gallery, Annarumma Gallery, SVIT Praha, and recently at the KMAC Museum in Louisville, Kentucky. He has an upcoming solo exhibition at Galerie Stadtpark Krems. Ajit Chauhan's art is in the collection of the San Francisco Museum of Modern Art, The Saatchi Gallery in London, the Berkeley Art Museum and Pacific Film Archive, the SONS Museum in Kruishoutem, Belgium, the Jan Shrem and Maria Manetti Shrem Museum of Art & others. He has completed artists residencies in Prague CZ (MeetFactory), Athens Greece (Snehta Residency), Krems Austria (AIR Niederösterreich), Sausalito CA (Headlands Center for the Arts), Woodside CA (Djerassi Resident Artists Program), San Francisco CA (de Young Museum) among others. Ajit Chauhan was the recipient of the TOSA Studio Award, a year long Residency that provided a private studio at Minnesota Street Project and a \$10,000 stipend.

**Julio del Rio** was born in El Tepehuaje, Michoacán, Mexico and immigrated to the United States when he was about 10 years old. He joined NIAD Art Center in 2007 when he was just 19 at the recommendation of his neighbor, close friend, and fellow NIAD artist Luis Estrada. Though it is difficult to conceive of, Julio asserts that he had no artistic inclination prior to joining NIAD. Julio's reserved demeanor belies his playful art practice. Working mostly in ceramics and drawing, he doesn't arrive at the NIAD studio with a plan in mind, but rather lets his momentary inspiration guide him. He works at a slow and steady pace, and with a repetition of mark-making that imbues his finished works with a beautifully layered complexity.



# Personal Space

**Christopher Robin Duncan** earned his BFA from the California College of Arts and Crafts and his MFA in Art Practice from Stanford University. He has exhibited nationally and internationally for two decades and is included in the permanent collections of the Berkeley Art Museum, Berkeley CA; the Kemper Art Museum, St. Louis MO; the Museum of Modern Art, New York NY; the Crocker Art Museum, Sacramento CA; and the San Francisco Museum of Modern Art, San Francisco CA. He is represented by Rebeca Camacho in San Francisco.

**Sam Finkelstein** (b. 1992, New York) lives and works in Rockland, ME. Sam bought their first hammer and chisel on the way up to visit a friend in Thomaston four years ago and has been here carving rocks ever since. The forms they create are another lifecycle in the sequence of boulders birthed by mountains, and mountains birthed by the primordial magma flowing beneath the Earth's crust. Sam's use of industrial tools allows them to embody natural geologic processes of transformation at an expedited rate. Wind is channeled through compressed air, water and grit mimic the fluid abrasion that polishes river beds and stones on a shoreline. Sam's work considers the weight of what we decide to memorialize and the illusion of permanence, while also embracing the humorous and futile activity of banging against a rock in search of answers.

**Gabriel Garza** is an artist living and working in Oakland, CA. He primarily works with found text to create sculpture interpreted from drawings.

**Gordon Hall** is a sculptor, performance-maker, and writer based in New York. Hall has presented solo exhibitions at EMPAC (2014), Temple Contemporary (2016), The Renaissance Society (2018), MIT List Visual Arts Center (2018), and Portland Institute for Contemporary Art (2019). Hall's sculptures and performances have been exhibited in a variety of group settings including Museum of Contemporary Art Chicago (2010), SculptureCenter (2012), Movement Research (2012), Brooklyn Museum (2014), White Columns (2015), Whitney Museum of American Art (2015), Hessel Museum at Bard College (2015), Art in General (2016), Wysing Arts Centre (2017), Abrons Arts Center (2017), Socrates Sculpture Park (2017), The Drawing Center (2018), David Zwirner New York (2018), Verge Center for the Arts (2019), Center for Maine Contemporary Art (2021), and AIR Gallery (2021). Hall's work has been covered in Artforum, Artsy, Art in America, V Magazine, Randy, Bomb, Flash Art, Title Magazine, Interior Design Magazine, and Mousse Magazine, and they have published essays in *Theorizing Visual Studies* (Routledge, 2012), *Art Journal* (2013), *What About Power? Inquiries Into Contemporary Sculpture* (SculptureCenter/Black Dog Press, 2015), *Documents of Contemporary Art: Queer* (Whitechapel/MIT Press, 2016), and *Art in America* (2018), among many other contexts. Hall holds an MFA and an MA in Visual and Critical Studies from the School of the Art Institute of Chicago and a BA from Hampshire College. Gordon Hall is represented by DOCUMENT in North America and Hua International in Europe and Asia.

**Justine Kablack** is an artist based in Rockland, ME. In 2013, she received a BFA from the Maryland Institute College of Art. Kablack has had solo exhibitions at Stellarhighway, Brooklyn, NY; Buoy Gallery, Kittery, ME; and SISTERED, Portland, ME. Her work has been included in group exhibitions at Rachel Uffner in New York, NY and Mrs. in Queens, NY. She has been an artist in residence at the Vermont Studio Center in 2014 and the Ellis-Beauregard Foundation in 2020 and 2023.



# Personal Space

**Em Kettner** (b. 1988, Philadelphia, PA) makes miniature drawings, tapestries, and sculptures that seek the humor and power in our most vulnerable moments. Her recurring cast of characters merge together in sex, birth, and sickbeds—in each case insisting that nothing is too sacred to be comical, or to be shared. Recent solo exhibitions include “Sick Joke” at Chapter (New York, NY) and “Slow Poke” at François Ghebaly Gallery (Los Angeles, CA). Her sculptures are currently featured in "Tender Loving Care: Contemporary Art from the Collection" at the Museum of Fine Arts, Boston, through July 2025. Em's work has been reviewed and published in ArtForum, Art in America, Sculpture Magazine, Contemporary Art Review LA (CARLA), HyperAllergic, Institutional Model, Sixty Inches From Center, and Fulcrum Arts: Sequencing. She earned her BFA from the University of the Arts in Philadelphia and an MFA from the School of the Art Institute of Chicago. Em is represented by François Ghebaly Gallery in Los Angeles and New York.

**Connie Lee** was born in San Diego, CA and received her BA in studio art from Mills College. There she was recipient of the Wellhausen Family Award and the Center for the Book Award for Excellence in Book Art. Her current practice includes drawing and printmaking as mediums for reshaping past experiences, often by centering the tactile details of significant events and domestic interiors. In recent years she has exhibited in group shows throughout the Bay Area and currently enjoys contributing illustrations to poetry and short story publications.

**Susan Metrican** is an artist living and working in Fairfield, IA via Boston, NYC, Toronto, and Bangkok. Metrican received an MFA from the Massachusetts College of Art and Design, her BFA from the Kansas City Art Institute, and attended Skowhegan School of Painting and Sculpture in 2014. Metrican's work has been included in solo and group exhibitions nationally; Rivalry Projects (NY), Tracey Morgan Gallery (NC), Maharishi University (IA), SPRING/BREAK Art Show 2017 (NY), Able Baker Contemporary (ME), GRIN Contemporary (RI), Proof Gallery (MA), Boston Center for the Arts (MA), Field Projects (NY), Knockdown Center (NY), and Gallery Protocol (FL). Metrican has an artist edition with Drawer NYC (NY), and has been featured in Cream City Review and ART MAZE Mag. She is one of four founding members of kijidome, an experimental project space and collaborative in Boston, MA (2013-2017). She was the Curator at the Kniznick Gallery at Brandeis University (Waltham, MA) from 2014-2022.

**Sandra Ono** is an interdisciplinary artist who lives and works in Berkeley, California. Ono has exhibited in Texas, New York, and throughout California. She has completed residencies at Headlands Center for the Arts, University of Texas at Dallas, Southern Exposure, Vermont Studio Center, Mascot Studio, Minnesota Street Project as a recipient of the TOSA Studio Award, and Kala Art Institute as a recipient of the Kala Fellowship Award.

**Sara Osebold** is a visual artist based in Seattle who works in sculpture and drawing. She received her BFA from University of Washington in printmaking and MFA from Pratt Institute (NY) in sculpture. Her works reside in private collections in the US and overseas. She has exhibited nationally and internationally in New York, Boston, New Haven (CT), Portland (OR), Japan, The Netherlands and various art venues in Seattle and within the state of Washington. She continues her childhood pursuit of collecting rocks with exceptional textures.



# Personal Space

In **J Rivera Pansa's** mixed media works, abstraction and representation are not necessarily opposites, meeting instead along the way in symbolism and allegory. Pansa's subdued, sculptural studies of shape and color draw from craft traditions such as chain maille, stained glass, and binakul textiles from the Philippines, each with their own particular spiritual and historical uses. Subtle incorporation of plant material and landscape imagery, mixed with formal references that simultaneously evoke modernist grids and bondage furniture, add further layers to Pansa's brutalist compositions, which protect a merciful, melancholy spirit within.

**Mel Prest** is an American abstract artist whose work is focused on color and perceptual visual relationships. Her work is held in private and public collections internationally. As an independent curator, Prest has organized shows across California and New York, and from Amsterdam to Zagreb. My paintings and glass pieces are inspired by nature, which is always changing. I highlight these ephemeral moments by using fluorescent, metallic, or phosphorescent material and mica that flickers, glows or is shadowed in different light conditions. The feeling of slipping time and optical confusion remind the viewer that you are seeing something unknown reveal itself, become something in front of you.

**Tracy Ren** is a multidisciplinary artist working primarily within the realm of sculpture. They are currently in the process of reorienting themselves and their practice.

**Julio Rodriguez** is a visual artist born and raised in the SF Bay Area. He received his BA in Studio Art/ Art History from San Francisco State University in 2016. He has exhibited in several group shows locally and currently works in the Exhibitions department at NIAD Art Center in Richmond, CA.

Drawing upon conventions of trompe l'oeil and the readymade, **Chris Thorson** uses a range of materials and methods to remake ordinary objects such as toiletries, food, and clothing to address themes of consumption, illusion and vulnerability. Her work has been featured in solo exhibitions at Quint Gallery in San Diego, CA; Ampersand International Gallery in San Francisco in San Francisco, CA; Rena Bransten Gallery in San Francisco, CA; Mama's in Vallejo, CA; and The Napa Valley Museum in Yountville, CA. Group exhibitions include Subsidiary Projects in London, UK, The Hessel Museum at Bard College; Des Lee Gallery at Washington University in St. Louis; and Headlands Center for the Arts in Sausalito, CA. Her work has been featured in The San Francisco Chronicle, The Riverfront Times, Art Practical, KQED, SFAQ, and New American Paintings. She received a BFA from Washington University in St. Louis and an MFA at San Francisco Art Institute. She lives and works in Vallejo, CA.

